

7 | Inspection / Maintenance

It is recommended to replace the filter element (s) when:

- the differential pressure reaches 1.4 bar
- chlorine breaks through,
- or after 3 months at the latest.

7.1 Replacement of the filter element(s)

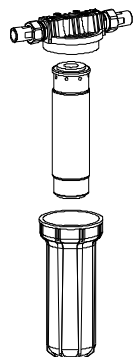

Procedure

1. Close the shut-off valves.
2. Slowly open the deaerating valve to make sure that the housing no longer is under pressure.
3. Remove the filter cylinder from the filter head.
4. Drain the filter cylinder and discharge the filter element(s). Clean all components, if necessary.
5. Insert new filter element(s) into the filter.

Note: When using the filter element with order no. 109 615, the circumferential bores at the outer shell of the element must be mounted upwards.

6. Remount the filter cylinder at the filter head.
7. Open the shut-off valve again and deaerate (see Start-up).
8. Check the filter for leakage.

8 | Consumables

Designation	Order no.
Activated carbon filter element 250-M	109 615

Consumables can be obtained from the sanitary specialised trade or from Grünbeck's technical service.

When inquiring, please indicate the filter type and the serial number (indicated on the type designation plate or the original packing).



Note: Seals are wearing parts.

Although these are wearing parts, we grant a limited warranty period of 6 months for them.

9 | Accessories

Designation	Order no.
Differential pressure monitoring of the filter	Please inquire

10 | Pressure loss curve



Abb. 2: Pressure loss curve GENO-activated carbon filter AKF 300, 600, 1100

Operation manual GENO-activated carbon filter AKF



GENO- activated carbon filter
AKF 300

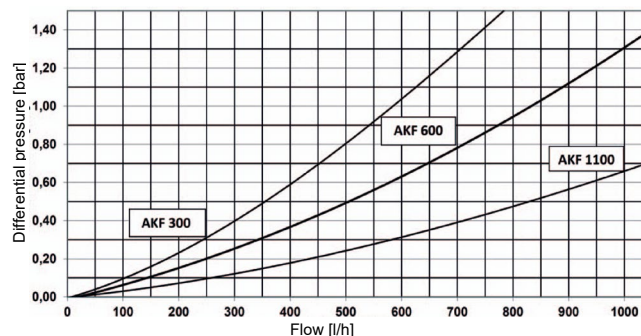
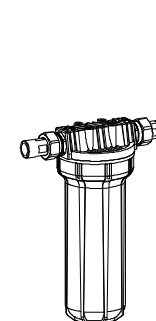
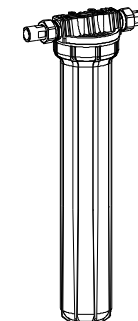

GENO- activated carbon filter
AKF 600

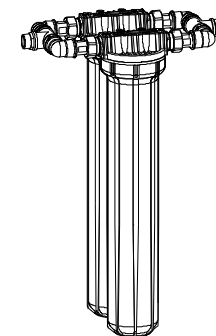

GENO- activated carbon filter AKF 1100

Edition August 2019
Order no. 036 109 960-inter

Grünbeck Wasseraufbereitung GmbH
Josef-Grünbeck-Str. 1 · 89420 Hoehstaedt
GERMANY
☎ +49 9074 41-0 · 📠 +49 9074 41-100
www.gruenbeck.com · info@gruenbeck.com



A company certified by TÜV SÜD
in accordance with DIN EN ISO 9001,
DIN EN ISO 14001 and SCC

General information

The installation may only be performed by water companies or approved installation companies. In Germany, the installation company must be registered in a water company installation directory as per §12(2) AVBWasserV (German Ordinance on General Conditions for the Supply of Water).

Protect the devices against frost and do not install them next to heat sources with high radiation temperature.



Attention: Do not clean the filter with cleaning agents that contain alcohol or solvents!

For drinking water that contains a lot of coarse dirt, a coarse filter must be installed upstream.

1 | Designated application

The activated carbon filter GENO-AKF is designed for the dechlorination of water with a chlorine concentration less than 0.2 mg/l in the feed pipe of a reverse osmosis systems. The water must be free of mechanic impurities.

2 | Technical specifications

GENO- activated carbon filter		AKF 300	AKF 600	AKF 1100
Connection data				
Connection size		¾" male thread		
Nominal connection diameter		DN 20		
Performance data				
Flow rate	[l/h]	300	600	1100
Nominal pressure		PN 8		
Dimensions and weights				
Installation length wo piping *	[mm]	163		
Installation length with piping *	[mm]	249		382
Total height	[mm]	305	565	
Clearance required for replacement	[mm]	360	620	
Empty weight	[kg]	1.9	2.7	6.5
E Filter diameter	[mm]	120		
F Centre distance	[mm]	140		
Ambient data				
Filter element(s)		1	2	4
Water temperature max.		[°C] 30		
Ambient temperature max.		[°C] 40		
Order no.		109 150	109 160	109 170

*or screw connections

3 | Installation requirements

Local installation guidelines and general regulations must be observed.

The installation site must ensure the protection of the filter against chemicals, dyes, solvents, vapours and direct sunlight. The ambient temperature as well as the radiant temperature in the immediate vicinity must not exceed 40 °C. The installation site must be frost-proof.

The filter must be installed in equally dimensioned pipes according to its nominal diameter.

The GENO-activated carbon filter AKF must be preceded by a drinking water filter.

The installation site must provide a floor drain. If this is not the case, an appropriate safety device must be installed.



Warning! Floor drains that are channelled off to the lifting system do not function in case of a power failure.

4 | Supplied components

GENO-activated carbon filter AKF complete with filter element(s), brass screw fittings or brass screw piping and operation manual.

5 | Installation

The activated carbon filter must be installed in the cold water pipe downstream of a drinking water filter respectively upstream of the devices to be protected. Install shut-off valves upstream and downstream of the filters (refer to fig. 1).

Observe flow direction (➔ on the filter head).

Provide a pressure gauge upstream and downstream of the filter for inspection purposes.

The activated carbon filter is only suitable for horizontal installation.

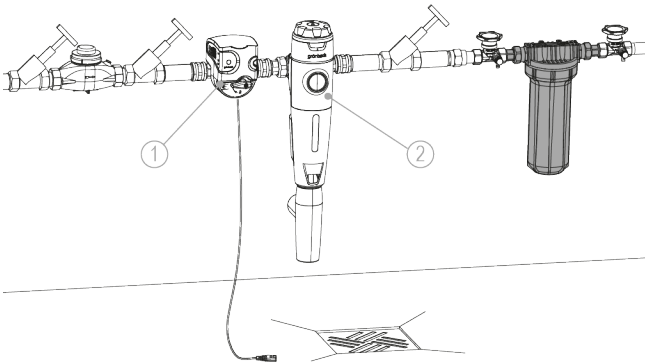

- ① Safety device protectliQ
- ② Drinking water filter pureliQ

Abb. 1: Installation drawing GENO-activated carbon filter AKF 300

6 | Start-up

Following the installation, put the filter into operation by opening the shut-off valves. Afterwards, deaerate the filter via the vent screw and the pipe via the nearest connection.

Leakage test
After the installation and after each maintenance, the filter must be checked for tightness by applying the highest, possibly occurring operating pressure and by visually checking the filter for leakage.